

C-122-263

Henry Landis
now
Andrew Morrison

Alexander Poor now
Martin Brand

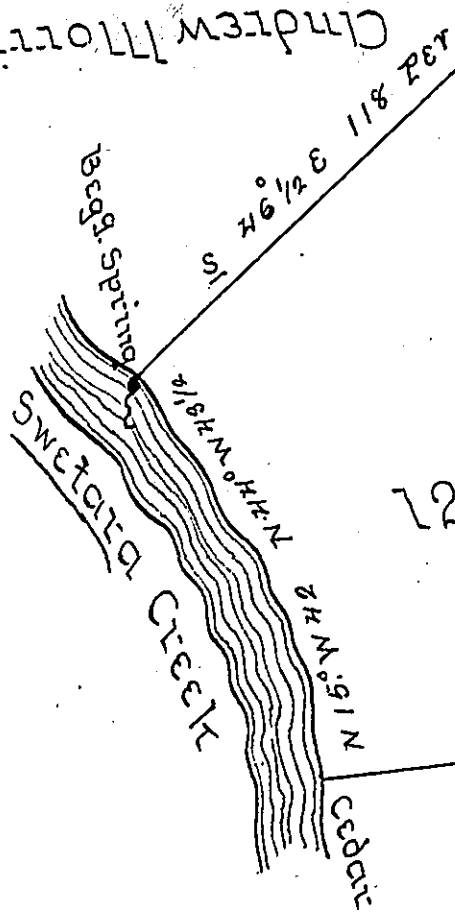

120 ac 35 1/2 & allow

Wendle Minch

Divided off on the 26th day of March 1808 for Henry Landis the above described tract containing one hundred & twenty acres & thirty five perches & allow^e of six per cent situate in Jerry Township Dauphin County being part of a larger tract granted to Hugh Hays by Warrant of the 8th day of February 1754

Levi Hollingsworth JS

To Saml Cochran Secy
Surveyor Genl of Penna

IN TESTIMONY that the above is a copy of the original remaining on file in the Department of Internal Affairs of Pennsylvania, made conformably to an Act of Assembly approved the 16th day of February, 1833, I have hereunto set my Hand and caused the Seal of said Department to be affixed at Harrisburg, this seventh day of March 1905.

Loach R. Brown
Secretary of Internal Affairs.